

67294

# ARE YOU



# Smart?



**Your essential guide to Kerbside  
Recycling in Nottinghamshire**



Nottinghamshire  
County Council



**Ashfield**



BASSETLAW  
DISTRICT COUNCIL  
NORTH NOTTINGHAMSHIRE



Broxtowe  
Borough  
COUNCIL  
Broxtowe, Mansfield, Radcliffe, and  
Stamford



Mansfield District Council  
Creating a Better Life for People and Places



NEWARK &  
SHERWOOD  
DISTRICT COUNCIL



Rushcliffe  
Borough Council



**VEOLIA**  
ENVIRONMENTAL  
SERVICES



## Welcome....

Nottinghamshire County Council, the District/Borough Councils and Veolia Environmental Services; are working in partnership to help increase the amount of waste you recycle, by improving the quality of recycling. We have created this guide to tell you more about this and how you can help us raise the quality of recycling in Nottinghamshire.

The information will tell you about the latest developments and what we're doing to improve facilities and more importantly, how you can do your bit.

On pages 4 and 5 you can find out exactly what you can put in your recycling bin and then pages 6 and 7 will show you what happens to the materials you recycle.

### Should I take the tops off plastic bottles?

**Yes please.** Lids on plastic bottles are made from a different plastic. Please take the lids off and put them in your general waste bin.



## Ignore all symbols on packaging

The labelling on recyclable packaging can be confusing at times. Although symbols like those above mean that it may be possible for an item to be recycled, this depends on the facilities available in your area to sort and reprocess these items.

In Nottinghamshire many items with these symbols on can be recycled, but many others such as soft plastic wrapping and other plastics like food trays and punnets cannot.

That is why we have produced this guide, so please refer to the itemised lists on pages 4 and 5 and the enclosed reminder card, to check what you can put in your recycling bin.

# A new recycling facility for Nottinghamshire

A new Material Recycling Facility (MRF) is being built in Mansfield. It is where your recycling will go to be screened, cleaned and bundled before being sent on to the companies that will re-use the materials.

When the brand new, state-of-the-art MRF opens in early 2009 it will process all of Nottinghamshire's recycling.

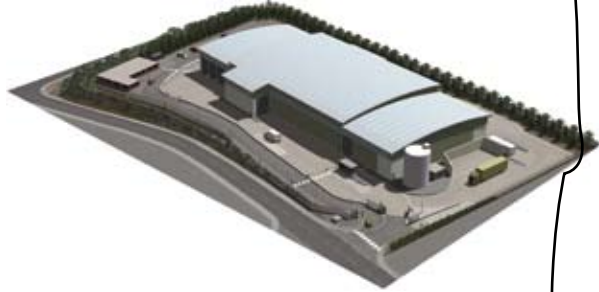

**ARE YOU BIN Smart?**

However, for the new MRF to work at its best, we need to reduce contamination in the recycling we collect from you. Contamination is when the wrong thing goes in the wrong bin and here is why it is so important to get it right;

- Even if just one wheelie bin contains the wrong thing, the whole load collected on that round can be rejected, meaning that it could all end up in landfill, wasting the efforts of many and costing additional money.
- Some contamination can also damage the equipment at the MRF. If this happens, we have to take the recycling to a different facility, costing more money and reducing the environmental benefits of recycling.

## How you can be “Bin Smart!”

We've put this guide together to help you get the best from your recycling bin collections. Please take a few moments to read through it and then keep it in a safe place so you can refer to it if ever you need reminding of what can and cannot be recycled.

We hope the enclosed reminder card will also be useful. Please put it somewhere convenient such as on a fridge or pinboard, so you can refer to it regularly.

**Thanks!**

# What you can put in your recycling bin...

Nottinghamshire is currently recycling nearly 40% of household waste. That's a fantastic achievement but we still need to make significant improvements, so please keep up the good work.

**Please note:** we cannot currently accept glass in your recycling bin. Your local district/borough council will provide other facilities for recycling glass.



## Still unsure what goes in?

Please refer to the reminder card enclosed, visit: [www.recyclefornottinghamshire.org.uk](http://www.recyclefornottinghamshire.org.uk) or contact your local council for more advice - all the contact details are on the back page.

# Plastic



Recycled plastic has many uses. It can be reformed into new plastic packaging, used in the textile industry and used to make park benches and decking. Recycling plastic saves huge amounts of oil, energy and space in landfills.



## ✓ Yes please

- Drink bottles
- Toiletry bottles
- Cleaning product bottles
- Margarine/butter tubs
- Yoghurt pots

## ✗ No thanks

- Ice cream tubs
- Plastic food cartons and trays
- Carrier bags
- Plastic pet food pouches
- Bottle tops and plastic lids
- Plastic bags
- Polystyrene

# Paper & cardboard



Paper can be recycled up to 7 times. After this, it can be used in packaging materials and even as part of new road surfaces.



## ✓ Yes please

- Newspapers & magazines
- Junk mail
- Directories e.g. Yellow Pages
- Brochures & leaflets
- Cardboard boxes (flattened)
- Cardboard food packaging (e.g. cereal boxes)
- Envelopes

## ✗ No thanks

- Tetra pak
- Milk cartons
- Juice cartons

# Cans



Cans are melted down to make new cans, cars, bikes...



## ✓ Yes please

- Food and drink cans (including pet food cans)
- Empty aerosol cans

## ✗ No thanks

- Foil and foil trays (including pet food trays)
- Metal lids (e.g. from glass jars and bottles)

# Where your recycling goes

Ever wondered what happens to your recycling when it's collected? See the diagram opposite



**Please don't forget to rinse all your bottles and cans...**

**because** it helps us to sort your materials and it can stop your bin smelling unpleasant.





Recyclable materials are collected from the kerbside by your local council.



This material is then taken to a Waste Transfer Station where the loads from each round are combined with loads collected from other rounds. This will then be sent onto the Materials Recycling Facility (MRF).

Some of the material is sent directly to the MRF

Products made from recycled material could be back in your home as a new item in as little as 4 weeks!

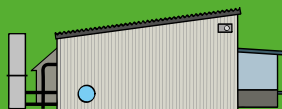

The MRF is a facility where the recycling is sorted and graded before being sent to various reprocessors to be made into new products.



### Aluminium & Steel

These items are sent to mills where they are melted down to make new cans and new steel, saving the need to extract valuable new resources from the Earth.



### Plastic

The various containers are graded into different plastic types to be made into new plastic containers. Some is reprocessed for use in the textile industry.

### Some materials separated into different material streams

No matter how diligent we are, there will always be a small amount of contamination that cannot be recycled. This can end up in landfill or be used to create energy. However too much contamination can lead to whole loads being rejected and landfilled.

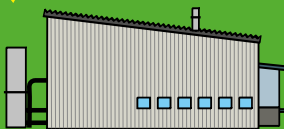

# Need more information?

**This booklet is intended to give you a general guide to recycling. If you have specific queries relating to your collection or local recycling services, please contact your council:**



## **Ashfield District Council**

Tel: 0800 183 84 84 • [www.ashfield-dc.gov.uk](http://www.ashfield-dc.gov.uk)

---



## **Bassetlaw District Council**

Tel: 01909 534501 • [www.bassetlaw.gov.uk](http://www.bassetlaw.gov.uk)  
Tel: 01909 533156

---



## **Broxtowe Borough Council**

Tel: 0115 917 7777 • [www.broxtowe.gov.uk](http://www.broxtowe.gov.uk)

---



## **Mansfield District Council**

Tel: 01623 463463 • [www.mansfield.gov.uk](http://www.mansfield.gov.uk)

---



## **Newark and Sherwood District Council**

Tel: 01636 650000 • [www.newark-sherwooddc.gov.uk](http://www.newark-sherwooddc.gov.uk)

---



## **Rushcliffe Borough Council**

Tel: 0115 981 9911 • [www.rushcliffe.gov.uk](http://www.rushcliffe.gov.uk)

---



## **Veolia Environmental Services**

Tel: 0115 988 2230  
[www.veoliaenvironmentalservices.co.uk/nottinghamshire](http://www.veoliaenvironmentalservices.co.uk/nottinghamshire)



Nottinghamshire  
County Council

## **Nottinghamshire County Council**

Trent Bridge House, Fox Road, West Bridgford, Nottingham, NG2 6BJ  
Tel: 08449 808080 • [www.recyclefornottinghamshire.org.uk](http://www.recyclefornottinghamshire.org.uk)

**If you or someone you know would like this information in a different format such as large print or Braille, or in a different language, please contact us.**

This booklet was designed and produced on recycled paper using sustainable printing techniques. When you have finished with it, please recycle it.